

CONSTANTO USER MANUAL

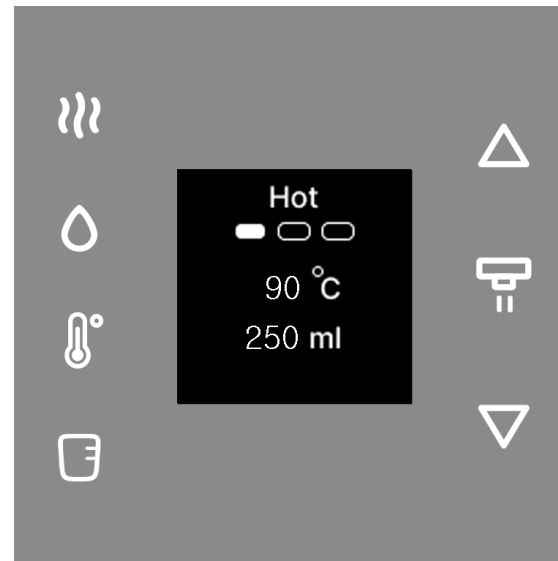



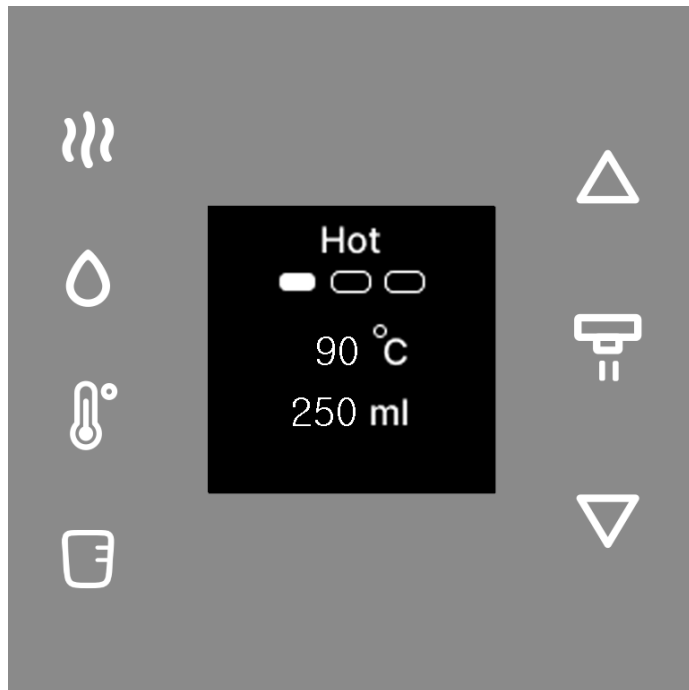

Power on

Once turn on the product, the logo appears on the screen, followed by the hot water dispensing screen.



Touch Button Functions



-  Displays three hot water settings repeatedly.
-  Displays three direct water settings repeatedly.
-  Adjusts the hot water temperature (direct water temperature cannot be changed)
-  Adjusts the water dispensing volume (applicable to both hot and direct water)
-   Used to modify the water volume or temperature.
-  Dispenses hot or direct water.

Button Operations

- Repeatedly displays set hot water menus.
- In menus 1 and 2, both temperature and water quantity can be adjusted.
- In menu 3, only the temperature can be set, and water continues to be dispensed maximum 2liters.
- Pressing anywhere on the screen during dispensing will stop the water flow.

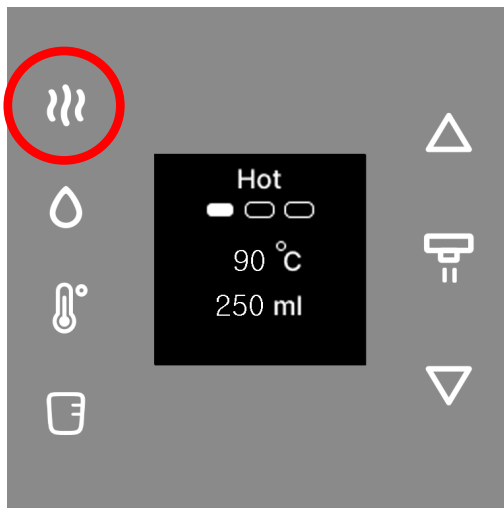

Menu 1

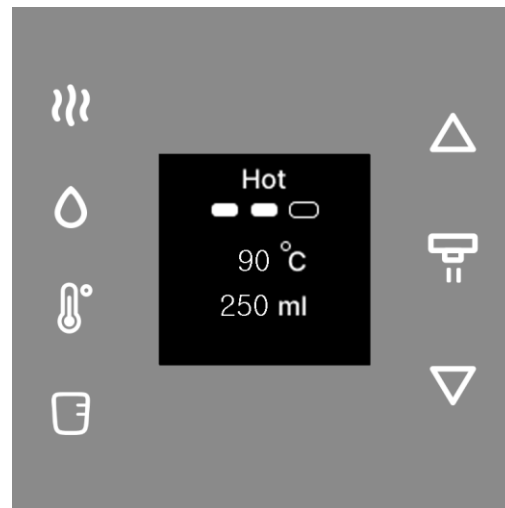

Menu 2



Menu 3



Button Operations

- Repeatedly displays set direct water menus.
- In menus 1 and 2, the water volume can be adjusted.
- In menu 3, water continues to be dispensed maximum 2liters.
- Pressing anywhere on the screen during dispensing will stop the water flow.

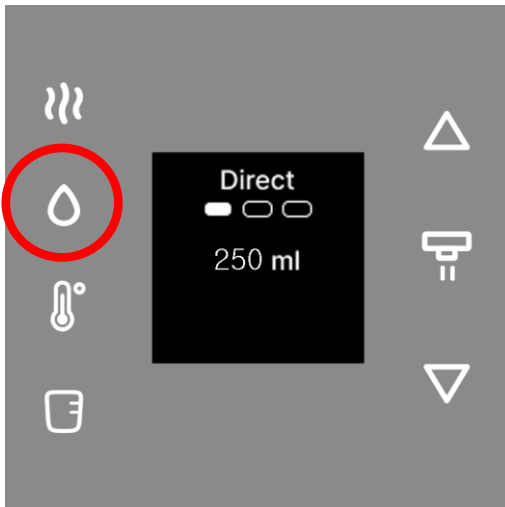

Menu 1

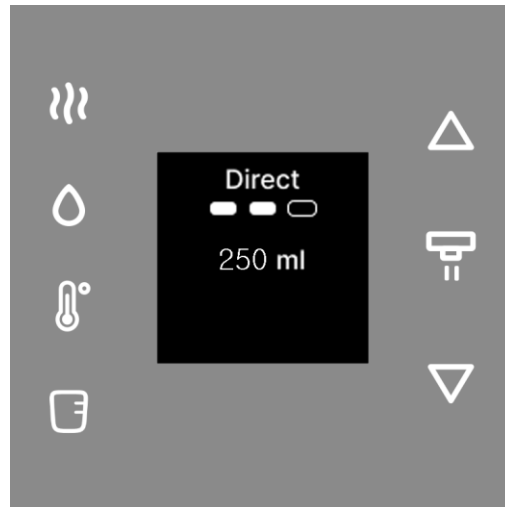

Menu 2

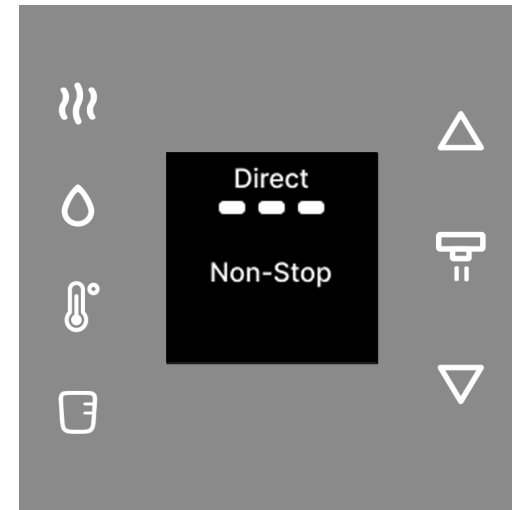

Menu 3

Adjusting Hot Water Temperature

Select the hot water menu with the A button to set.

Press button B to set temperature(the temperature will be underlined).

Press button C to increase the temperature or button D to decrease.

The temperature can be adjusted in 1°C increments within a range of 80–90°C.

Press button E to save the setting.

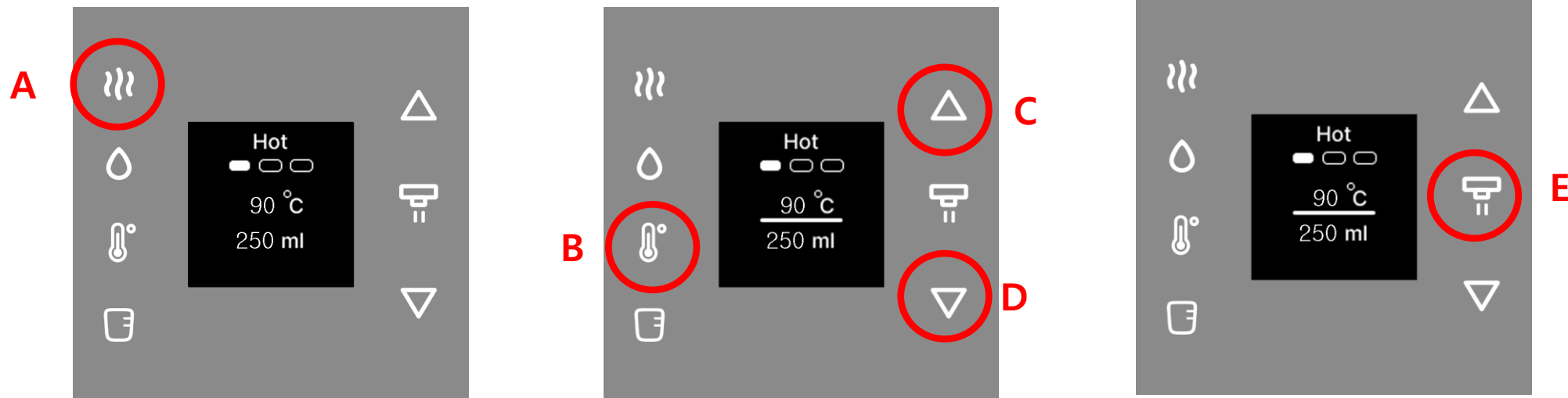

Adjusting Hot Water Volume

Select the hot water menu with the A button to set.

Press button B to set water volume(the volume will be underlined).

Press button C to increase the volume or button D to decrease.

The volume can be adjusted in **10ml increments**, within a range of **100ml–1,500ml**.

Press button E to save the setting.

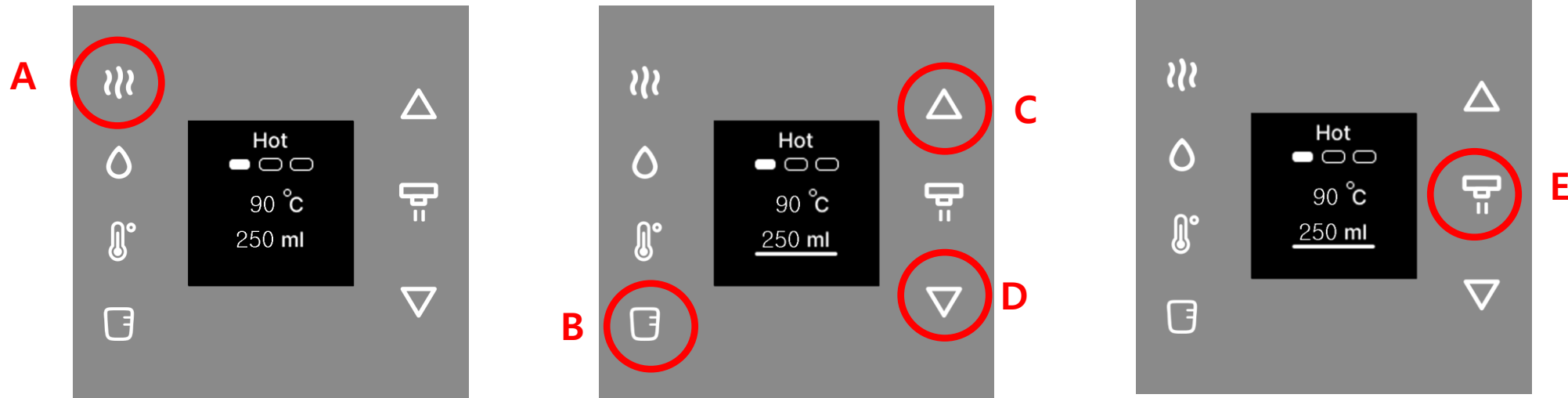

Adjusting Direct Water Volume

Select the direct water menu with the A button to set.

Press button **B** to set water volume(the volume will be underlined).

Press button **C** to increase the volume or button **D** to decrease.

The volume can be adjusted in **10ml increments**, within a range of **100ml–1,500ml**.

Press button **E** to save the setting.

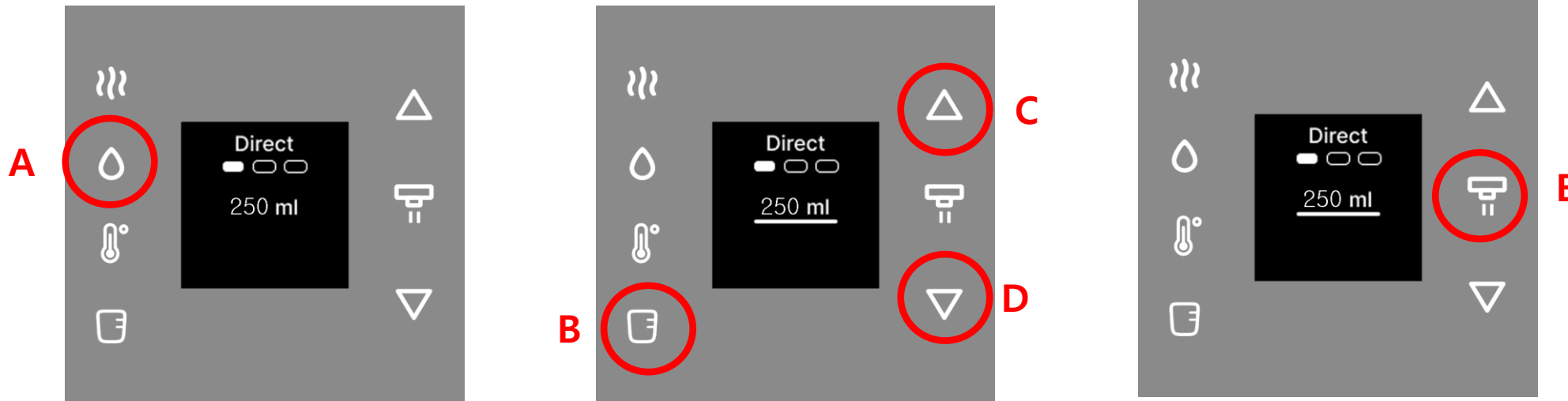

Settings

- Press **A** for 3 seconds on Direct water Menu to go to Settings
- Use **C** and **D** to choose the menu for setting

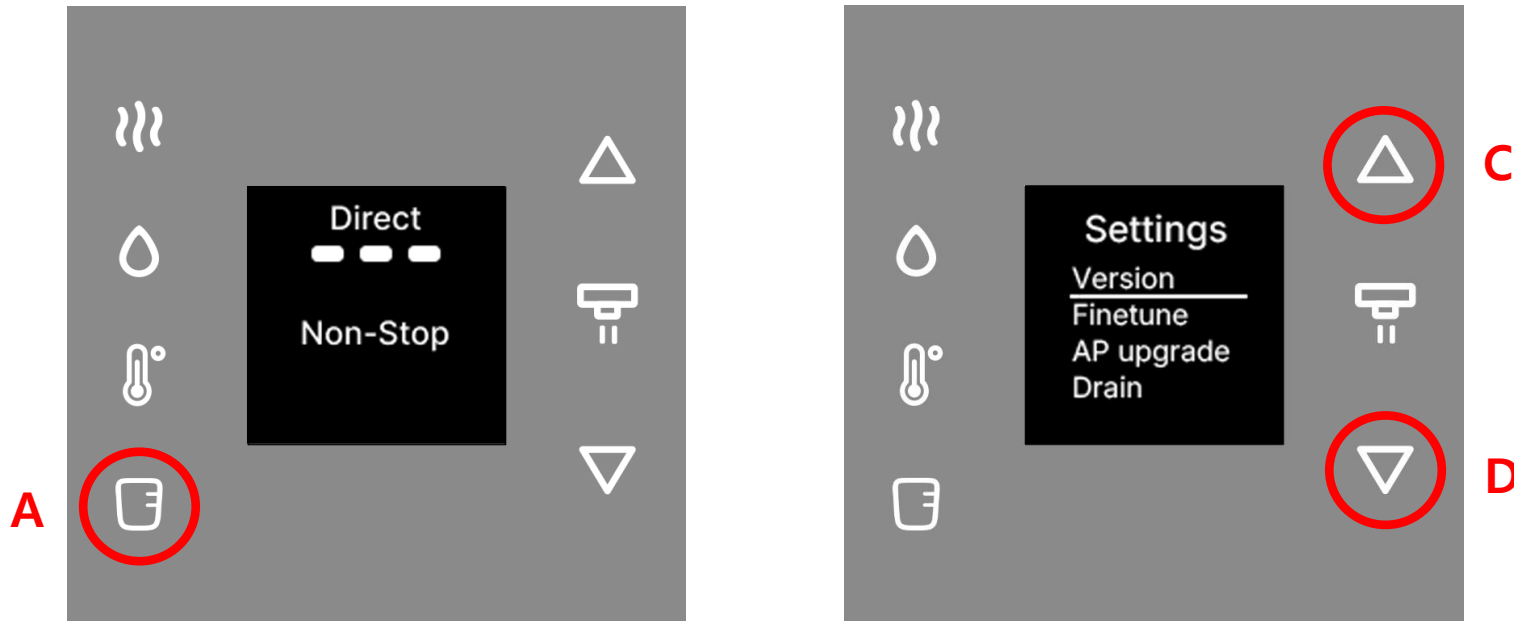

Settings : Version

- Please select A button to check the firmware version. Possible to go back to the previous menu with the same button.

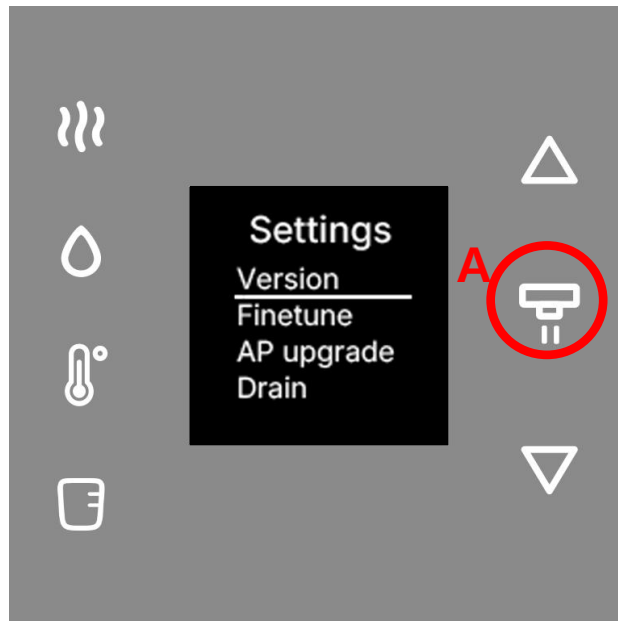

Settings : Finetune 1/2

- Please select A button to go to Finetune menu. Possible to go back to the previous menu with the same button.



그림1



그림2

Settings : Finetune 2/2

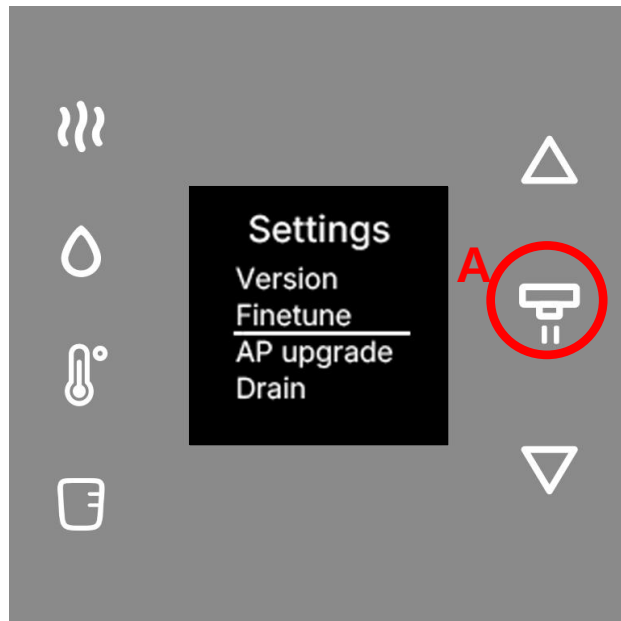
- If there is a tolerance in the water amount based on the temperature, it is possible to adjust the water amount.
- Select the temperature range to adjust the water amount by pressing the A or B icon
- The temperature options are 88–90 degrees, 84–87 degrees, 80–83 degrees, and Direct.
- Choose the temperature and use the C/D icons to adjust the water amount. The possible adjustment range is -20% to +20%, and it can be adjusted in 1% increments.
- Once the adjustment is complete, press the E button to save the changes.

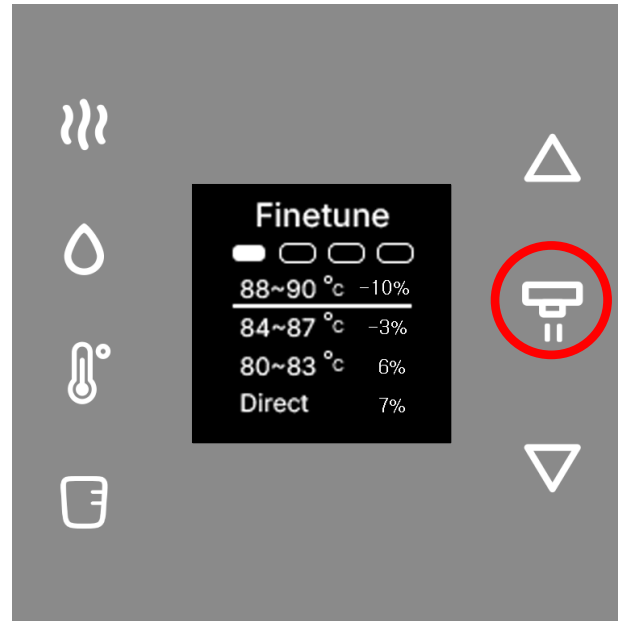
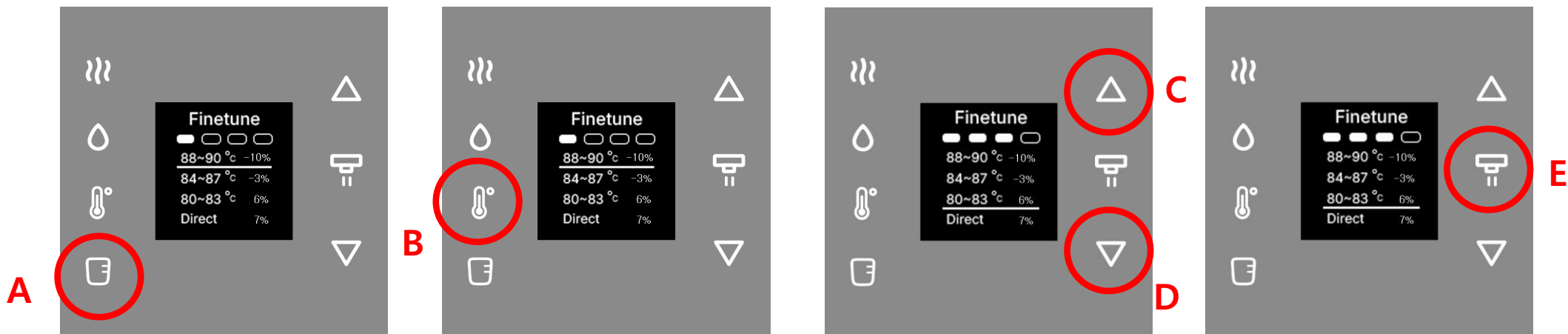

Settings : Ap upgrade

- AP upgrade is for upgrading Constanto's firmware using a WiFi-enabled device (e.g., laptop, mobile phone).
- When you enter the AP upgrade menu, your product's AP is displayed as BrewvieAPxx, where xx is a random number.
- Connect to BrewvieAPxx via WiFi from your laptop or mobile phone.

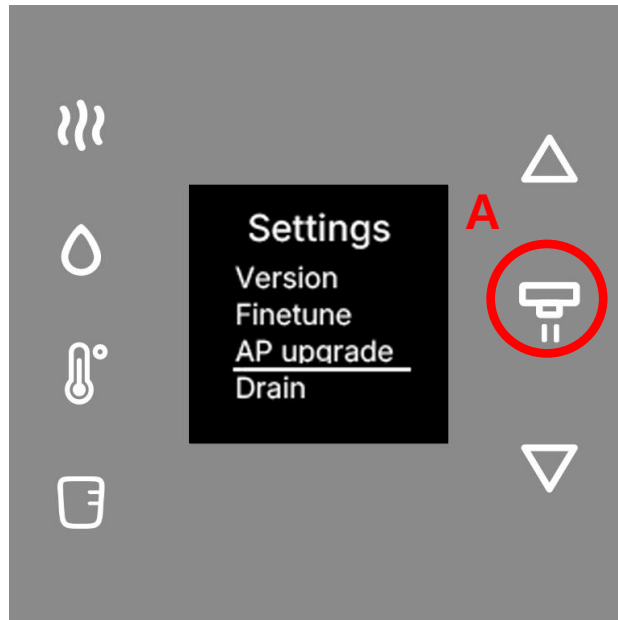

Constanto WiFi Manager Connection (Android)

1. Press Wi-Fi (A) and find the AP named "BrewvieAPXX" (B), where xx is 1–99
2. Select the AP named BrewvieAPXX (B) to connect, and press the Settings icon (C).
3. Press Manage Router (D).
4. After a moment, the WiFi Manager will be displayed as shown in the picture on the right.

* When WiFi is not connected, the AP name (BrewvieAPxx) changes every time the power is turned on.

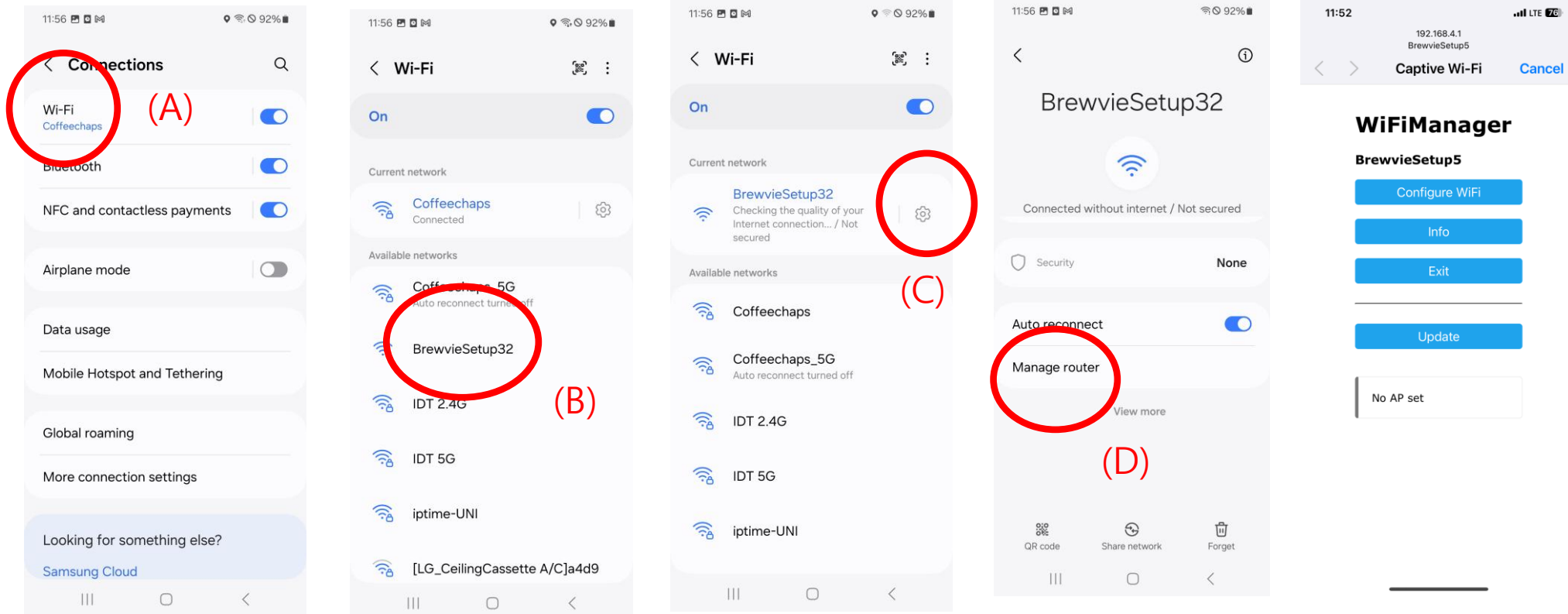

Constanto WiFi Manager Connection (iPhone)

1. Tap Settings → Wi-Fi and find the AP named "BrewvieAPXX" (A), where xx is 1~99.
2. Select and connect to the AP named BrewvieAPXX ("A") and press the icon (B).
3. Click Learn more about .. (C)
4. After a moment, the WiFi Manager will be displayed as shown in the picture on the right.

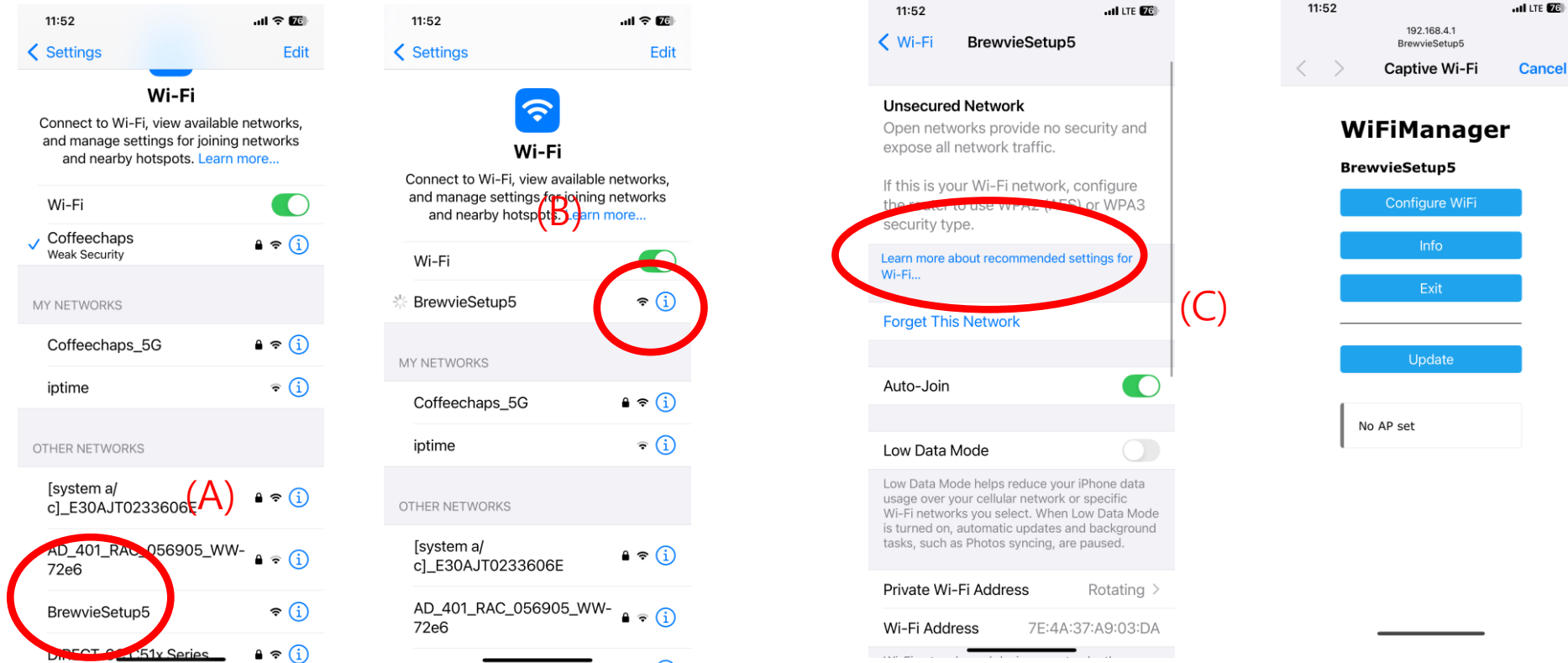

Firmware update (if you have a new firmware file)

- Once connected, select **A**(Update)
- Press the **B** button to select the firmware file you have, then proceed with **C**(Update).
- Press the Update button once and wait without doing anything else.
- When the firmware update is complete, the device will restart.
- If you press any button other than the designated one during the Update operation, an error may occur.

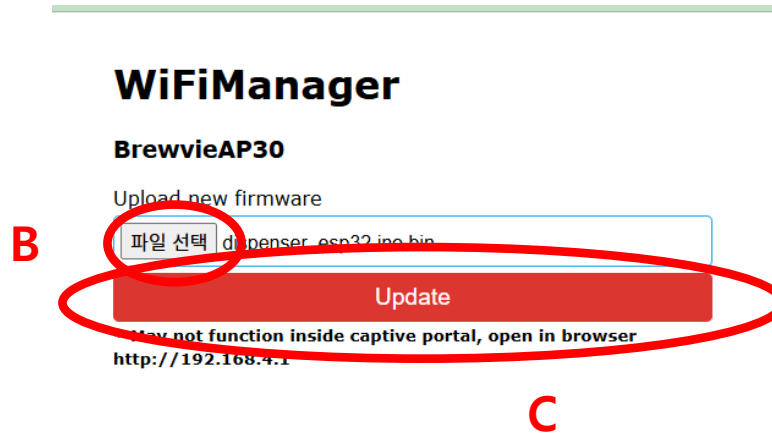

Automatic firmware update using OTA(over the air)-1

- Once connected, select A(Configure WiFi) when upgrading from a server connected to an external network
- Select an available WiFi, enter the SSID and password(**B**), and then press the **C** (Save) button. At this time, the WiFi must use 2.4Ghz.
- If you enter the correct SSID and password, the contents of the image below will be displayed.

WiFiManager

BrewvieAP30

Configure WiFi

Info

Exit

Update

No AP set

A

jmrusa
KT_GiGA_2G_Wave2_667A
KT_GiGA_VISKOR
KT_GiGA_2G_KIC
exanet
KT_GiGA_2G_Wave2_E90A
dlink-604m-z
geulim_2.4G
olleh_WiFi_B410
DIRECT-6C C51x Series
KT_GiGA_EBB4
shinwoo
Sungchang 2.4
test_wr4000
nptech

B

SSID
Password
Show Password

Save

C

No AP set

Saving Credentials
Trying to connect ESP to network.
If it fails reconnect to AP to try again

Automatic firmware update using OTA(over the air)-2

- When connected to the network and a new firmware is found, it will be displayed as left image
- Press the **A** button to proceed with the update or press the **B** or **C** button to not proceed
- When the upgrade is in progress, the screen will change as image in middle, and the device will automatically restart when the upgrade is complete
- If there is no new firmware, it will be displayed as right image. Possible to go back to the previous menu with **D** button.

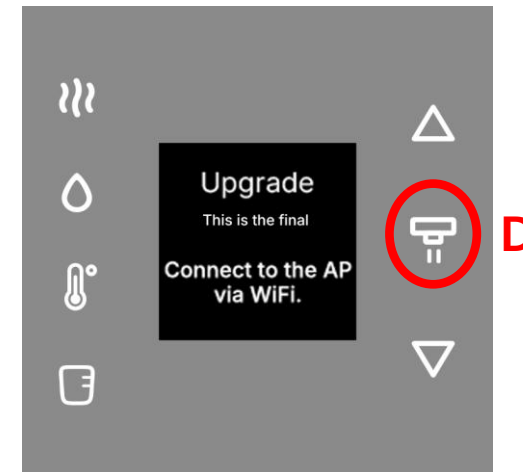
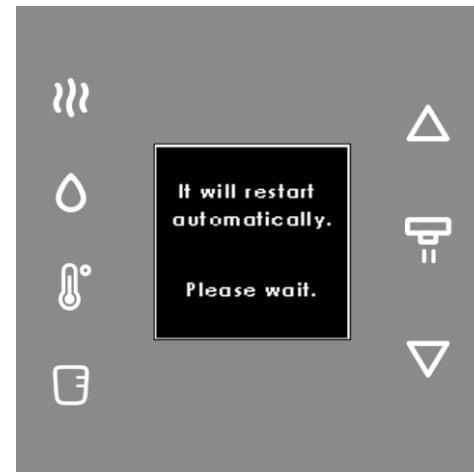
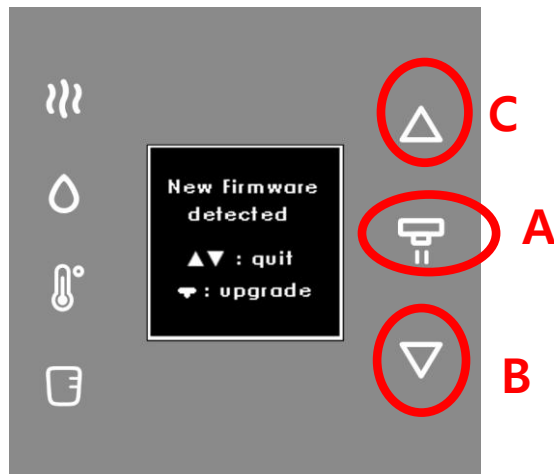

Drain

- You can remove water in the tank through Drain.
1. Prepare a device (such as a kettle) before Drain.
 2. Please select **A** button to go to Drain menu.
 3. Press **B** button to drain for up to 2 minutes.
 4. Press any key during the draining process to stop the drain.
 5. Possible to go back to the previous menu with **C,D** button.

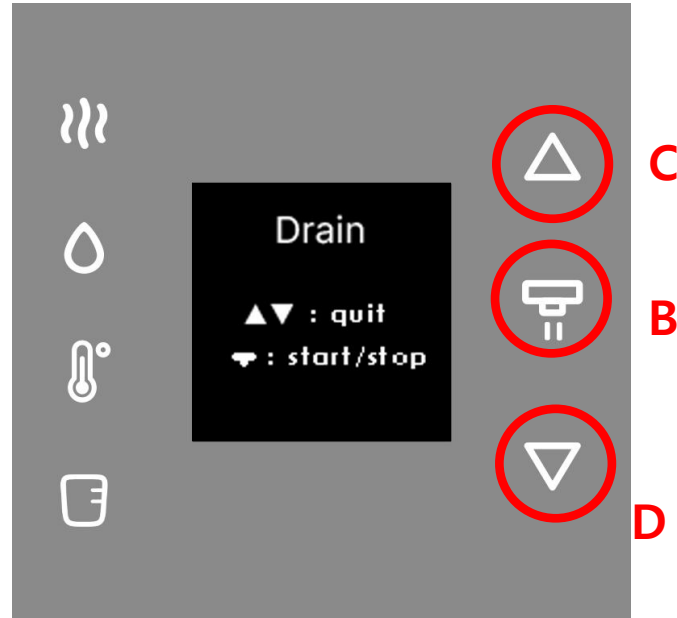
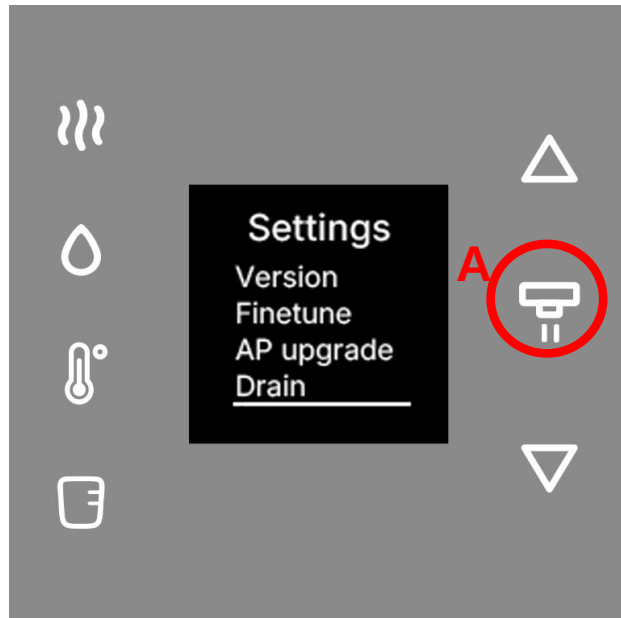

SPEC

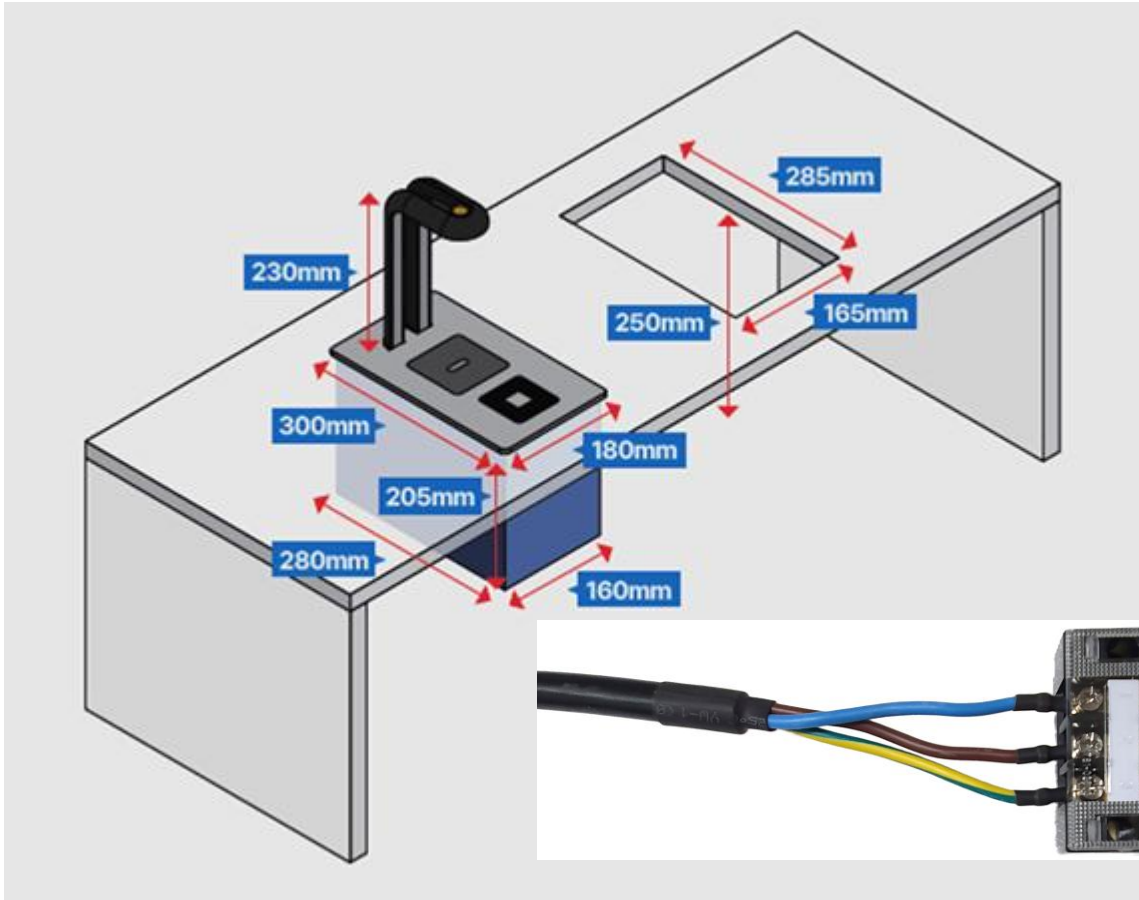

- **SIZE** : (W) 180mm X (L) 300mm X (H) 230mm
- **OPERATING(HOLE) SIZE** : (W) 165mm X (L) 285mm X (D) 250mm
- **CLEARANCE AROUND THE PRODUCT**:
MINIMUM 100MM ON ALL FIVE SIDES OF THE EMBEDDING AREA
- **VOLTAGE AND POWER CONSUMPTION** : 230V~50Hz 3,000w
- **HOT WATER TEMPERATURE RANGE** : 80°C ~ 90°C
- **WATER SUPPLY REQUIRMENT** : 0.6Mpa ~ 1Mpa
- **HOT WATER FLOW** : 600ml per minute
- **WEIGHT** : 7kg

